

# MOTOR ROTAX DD2 - 2013

## KURBELGEHÄUSE (Seite 1 von 2)

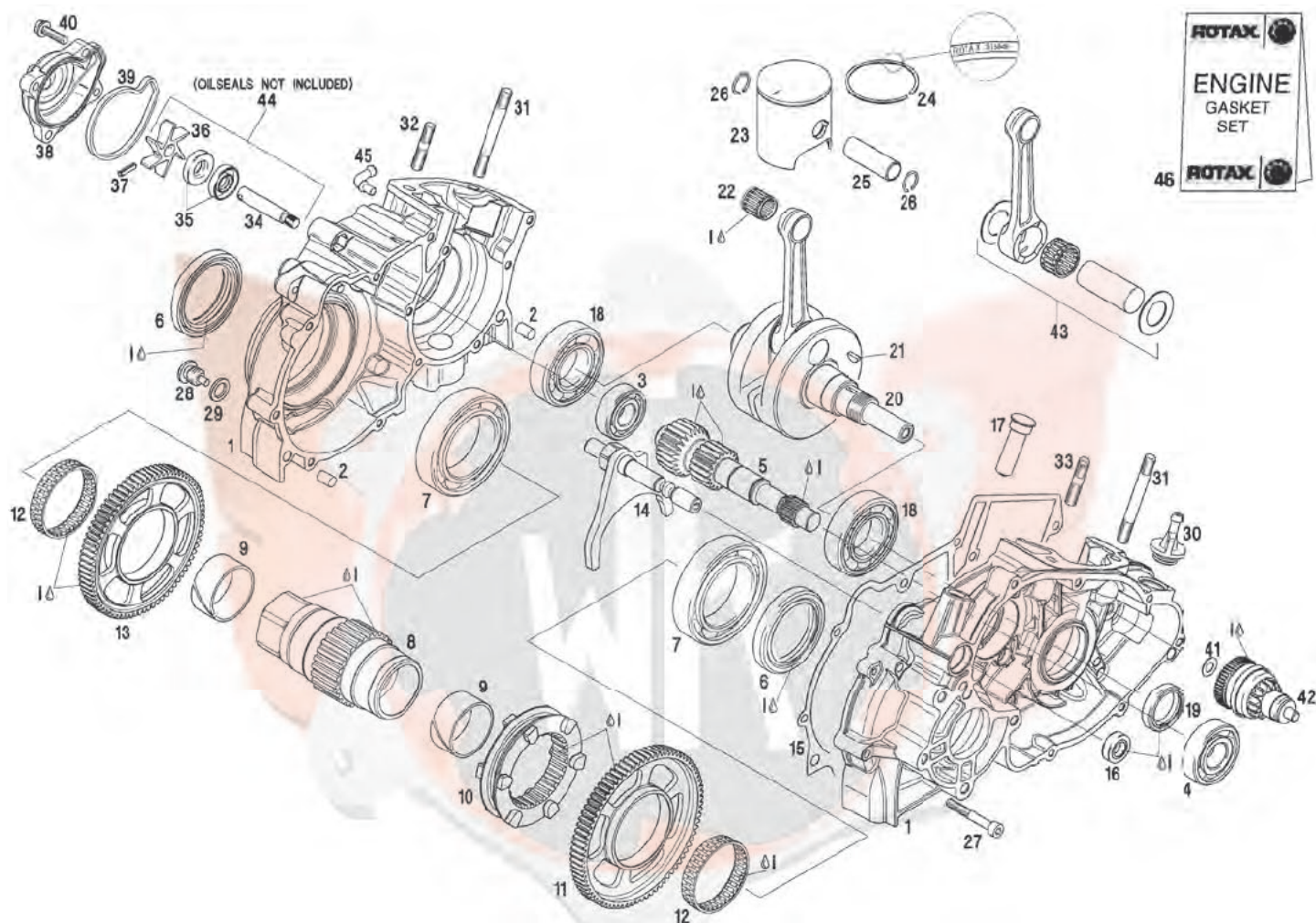

|       |          |  |                                      |  |
|-------|----------|--|--------------------------------------|--|
| 1 – 2 | RX684233 | Kurbelgehäuse DD2 komplett             | CRANKCASE ASSY. DD2                  | Carter moteur complet DD2                        |
| 2     | RX632010 | Zylinderrolle 8x12mm                   | PIN 8x12mm                           | Pin de centrage 8x12mm                           |
| 3     | RX932030 | Kugellager 6203 C3 17x40x12mm          | BALL BEARING 6203 C3, 17x40x12mm     | Roulement 6203 C3 17x40x12mm                     |
| 4     | RX932432 | Kugellager 6204 C3 20x47x14mm          | BALL BEARING 6204 C3, 20x47x14mm     | Roulement 6204 C3 20x47x14mm                     |
| 5     | RX620182 | Primärwelle 24/19 Zahn, ab 2012        | PRIMARY SHAFT 24/19 T as of 2012     | Arbre intermédiaire 24/19 dts à pd. 2012         |
| 6     | RX630500 | Simmerring 50x68x8mm                   | OIL SEAL 50x68x8mm                   | Joint spy 50x68x8mm                              |
| 7     | RX432330 | Kugellager 6010 C3 50x80x16mm          | BALL BEARING 6010 C3 50x80x16mm      | Roulement 6010 C3 50x80x16mm                     |
| 8     | RX620163 | Hohlwelle Antrieb kurz, bis 2010       | HOLLOW SHAFT up to 2010              | Arbre creux j.à 2010                             |
| 8     | RX620164 | Hohlwelle Antrieb kurz, ab 2011        | HOLLOW SHAFT as of 2011              | Arbre creux à pd. 2011                           |
| 9     | RX233120 | Lagerhülse 40x44x20mm                  | PLAIN BEARING 40x44x20mm             | Douille 40x44x20mm                               |
| 10    | RX257361 | Schaltmuffe, bis 2010                  | SHIFTING SLEEVE up to 2010           | Manchon de changement vitesse j.à 2010           |
| 10    | RX257362 | Schaltmuffe, ab 2011                   | SHIFTING SLEEVE as of 2011           | Manchon de changement vitesse à pd. 2011         |
| 11    | RX635700 | Zahnrad 81 Zahn (1.Gang) bis 2010      | IDLE GEAR 81 T, 1. GEAR, up to 2010  | Couronne 1ère vitesse 81 dts j.à 2010            |
| 11    | RX635702 | Zahnrad 81 Zahn (1.Gang) ab 2011       | IDLE GEAR 81 T, 1. GEAR, as of 2011  | Couronne 1ère vitesse 81 dts à pd. 2011          |
| 12    | RX632665 | Nadellager 52x57x12mm (Losrad 2. Gang) | NEEDLE BEARING 52x57x12mm            | Cage d'aiguilles 52x57x12mm                      |
| 13    | RX635710 | Zahnrad 77 Zahn (2.Gang) bis 2010      | IDLE GEAR 77 T, 2. GEAR, up to 2010  | Couronne 2ème vitesse 77 dts j.à 2010            |
| 13    | RX635712 | Zahnrad 77 Zahn (2.Gang) ab 2011       | IDLE GEAR 77 T, 2. GEAR, as of 2011  | Couronne 2ème vitesse 77 dts à pd. 2011          |
| 14    | RX257405 | Schaltgabel komplett                   | SHIFT FORK ASSY.                     | Fourchette changement vitesse complet            |
| 15    | RX630522 | Kurbelgehäusedichtung DD2              | GASKET CRANKCASE DD2                 | Joint de carter DD2                              |
| 16    | RX250455 | Simmerring 12x22x7mm                   | OIL SEAL 12x22x7mm                   | Joint spy de fourchette 12x22x7mm                |
| 17    | RX257422 | Schaltstangenarretierung               | SHIFT RAIL DETENT PIN                | Pin d'arrêt de fourchette                        |
| 18    | RX832533 | Kugellager 6206 TVH C4M 30x62x16mm     | BALL BEARING 6206 TVH C4M 30x62x16mm | Roulement de vilebrequin 6206 TVH C4M 30x62x16mm |
| 19    | RX930695 | Simmerring K-Welle 30x42x7mm DD2       | OIL-SEAL 30x42x7mm DD2               | Joint spy d'arbre intermédiaire 30x42x7mm DD2    |
| 20    | RX685010 | Kurbelwelle DD2 komplett               | CRANKSHAFT ASSY. DD2                 | Vilbrequin complet DD2                           |
| 21    | RX246015 | Scheibenfeder (Keil) 3x5mm             | WOODRUFF KEY 3x5mm                   | Clavette 3x5mm                                   |
| 22    | RX932026 | Nadellager Kolbenbolzen 15x19x20mm     | NEEDLE CAGE 15x19x20mm               | Cage d'axe de piston 15x19x20mm                  |



# MOTOR ROTAX DD2 - 2013

## KURBELGEHÄUSE (Seite 2 von 2)

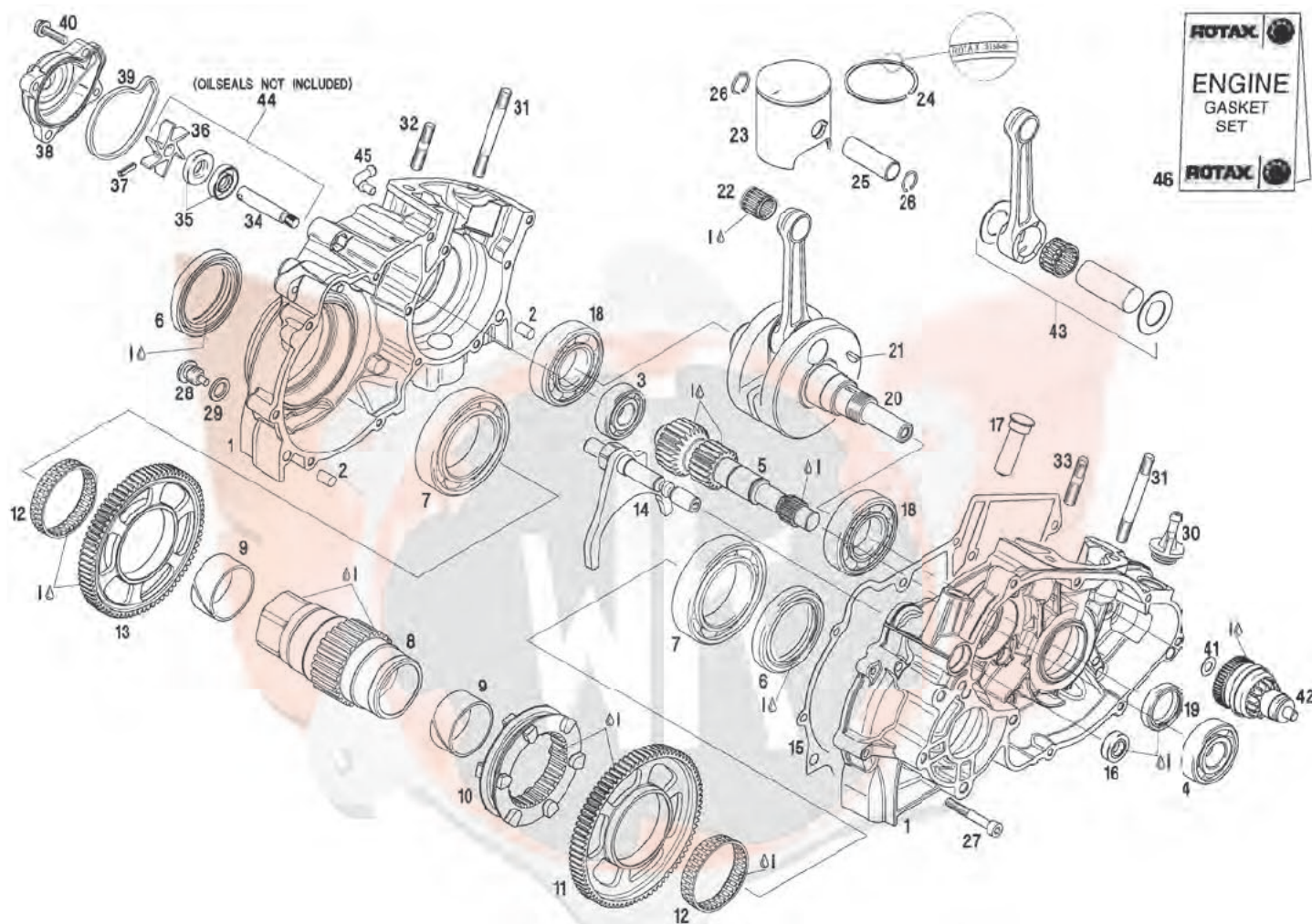

|         |          |  |                                       |   |
|---------|----------|--|---------------------------------------|---|
| 23 – 24 | RX296296 | Kolben 53,99mm (B-Zylinder) mit Ring         | PISTON ASSY. 53,99 MM                 | Piston complet 53,99mm (Cyl. B)                 |
| 23 – 24 | RX296297 | Kolben 53,97mm (A-Zylinder) mit Ring         | PISTON ASSY. 53,97 MM                 | Piston complet 53,97mm (Cyl. A)                 |
| 23 – 24 | RX296298 | Kolben 53,98mm (AB-Zylinder) mit Ring        | PISTON ASSY. 53,98 MM                 | Piston complet 53,98mm (Cyl. AB)                |
| 23 – 24 | RX296299 | Kolben 54,00mm (B-Zylinder+) mit Ring        | PISTON ASSY. 54,00 MM                 | Piston complet 54,00mm (Cyl. B+)                |
| 24      | RX215548 | Kolbenring IS2 54/49,4x1mm                   | PISTON RING IS2 54/49,4x1mm           | Segment de piston 54mm                          |
| 25      | RX216135 | Kolbenbolzen 15x10/12x45,6mm                 | PISTON PIN 15X10/12,5X45,6mm          | Axe de piston 15x10/12x45,6mm                   |
| 26      | RX945635 | Sicherungsring Kolbenbolzen 15mm             | CIRCLIP 15mm (USE ONLY ONCE)          | Clips d'axe de piston (utilisable 1x)           |
| 27      | RX241821 | Inbusschraube M6x45mm                        | ALLEN SCREW M6x45mm                   | Vis BTR M6x45mm                                 |
| 28      | RX241783 | Ablafschraube M12x1,5 mit Magnet             | MAGNETIC DRAIN PLUG M12x1,5           | Vis magnétique M12x1,5                          |
| 29      | RX250640 | Dichtring 12x18mm Ablafschraube              | SEALING RING COPPER 12x18mm           | Joint cuivre 12x18mm                            |
| 30      | RX241925 | Entlüftungsschraube M18x1,5                  | AIR VENT SCREW M18x1,5                | Bouchon reniflard d'huile M18x1,5               |
| 31      | RX940786 | Stiftschraube Zylinder M8x57mm               | STUD M8x57mm                          | Tirant de cylindre M8x57mm                      |
| 32      | RX241381 | Stiftschraube Zylinder M8x28mm               | STUD M8x28mm                          | Tirant de cylindre M8x28mm                      |
| 33      | RX241386 | Stiftschraube Zylinder gebohrt M8x28mm       | STUD M8x28mm WITH HOLE                | Tirant de cylindre M8x28mm avec perçage         |
| 35      | RX230195 | Simmerring W-Pumpe 10x26x7mm                 | OIL SEAL WATERPUMP 10x26x7mm          | Joint spy de pompe à eau 10x26x7mm              |
| 37      | RX229200 | Spannstift 4x16mm Wasserpumpenlaufrad        | DOWEL 4x16mm                          | Douille de serrage 4x16mm                       |
| 38      | RX222720 | Wasserpumpengehäuse                          | WATER PUMP HOUSING                    | Carter de pompe à eau                           |
| 39      | RX630770 | Schlauchring 61,5x1,5x3,5mm                  | RUBBER RING 61,5x1,5x3,5mm            | Joint de carter de pompe à eau 61,5x1,5x3,5mm   |
| 40      | RX941250 | Schraube M6x20mm selbstsichernd              | TAPTITE-SCREW M6x20mm                 | Vis TAPTITE M6x20mm                             |
| 41      | RX227945 | Anlaufscheibe 8,1x15x0,5mm                   | THRUST WASHER 8,5x15x0,5mm            | Rondelle 8,5x15x0,5mm                           |
| 42      | RX294810 | Startergetriebe komplett                     | STARTER REDUCTION GEAR ASSY.          | Lanceur de démarreur complet                    |
| 43      | RX295879 | Pleuelsatz                                   | CONROD ASSY.                          | Kit bielle complet                              |
| 44      | RX620275 | Wasserpumpenwelle DD2 kompl. (ohne WD-Ringe) | WATERPUMP SHAFT ASSY. (W/O OIL SEALS) | Axe de pompe à eau et turbine (sans joints spy) |
| 45      | RX924523 | Unterdruckanschluß                           | IMPULSE FITTING                       | Prise de dépression                             |
| 46      | RX296162 | Dichtungssatz Motor DD2                      | ENGINE GASKET SET ASSY. DD2           | Pochette complète pour moteur DD2               |
| 47      | RX281855 | Retrofit Kit „Getriebe DD2“                  | RETROFIT KIT PADDLE GEAR DD2          | Kit changement transmission DD2                 |
| I       | RX897330 | Fett auf Lithiumbasis, 250g                  | LITHIUM-BASE GREASE, 250gr.           | Graisse à base de lithium, 250 gr.              |